

## SECTION VIEW OF CANOPY

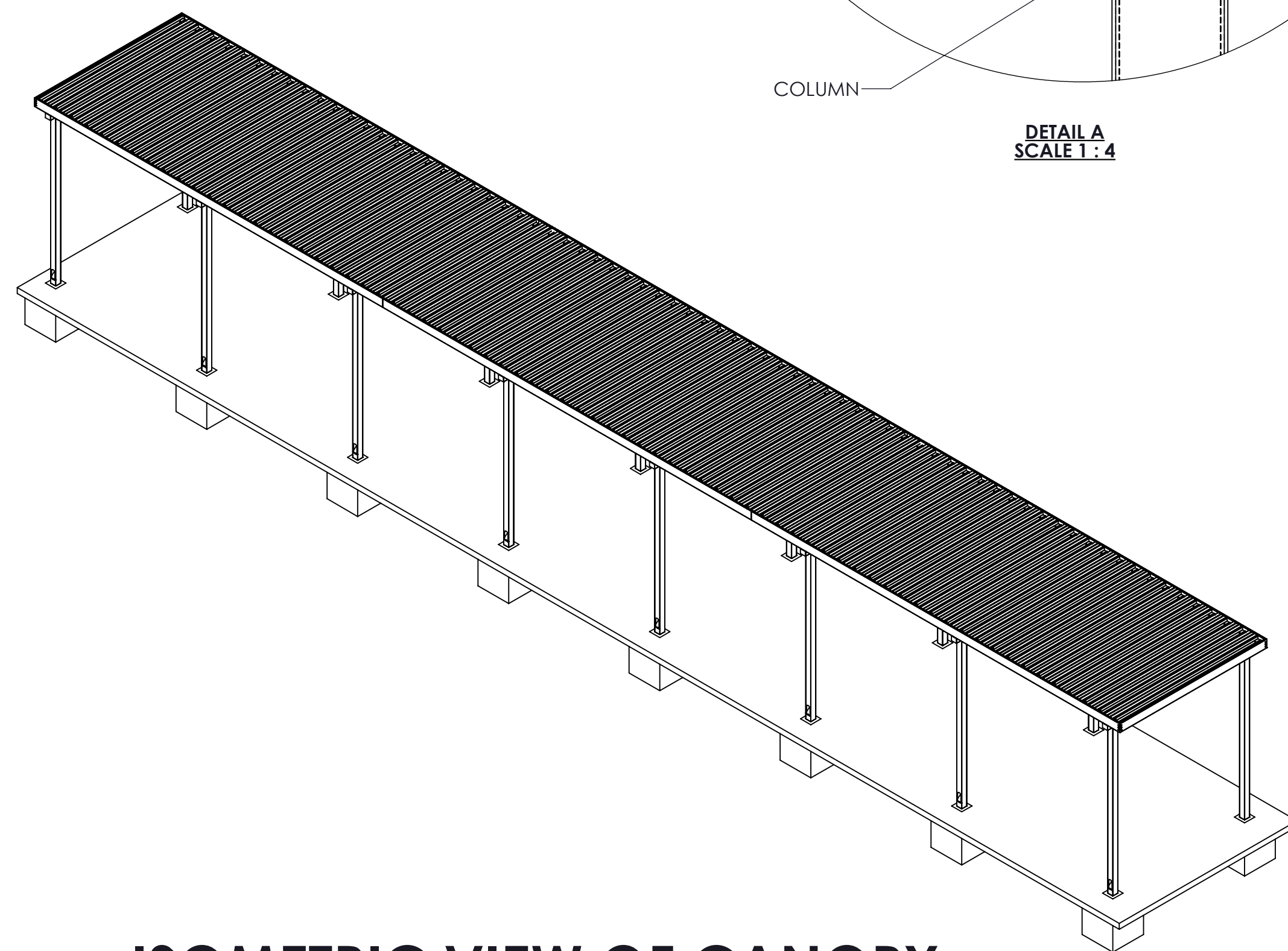
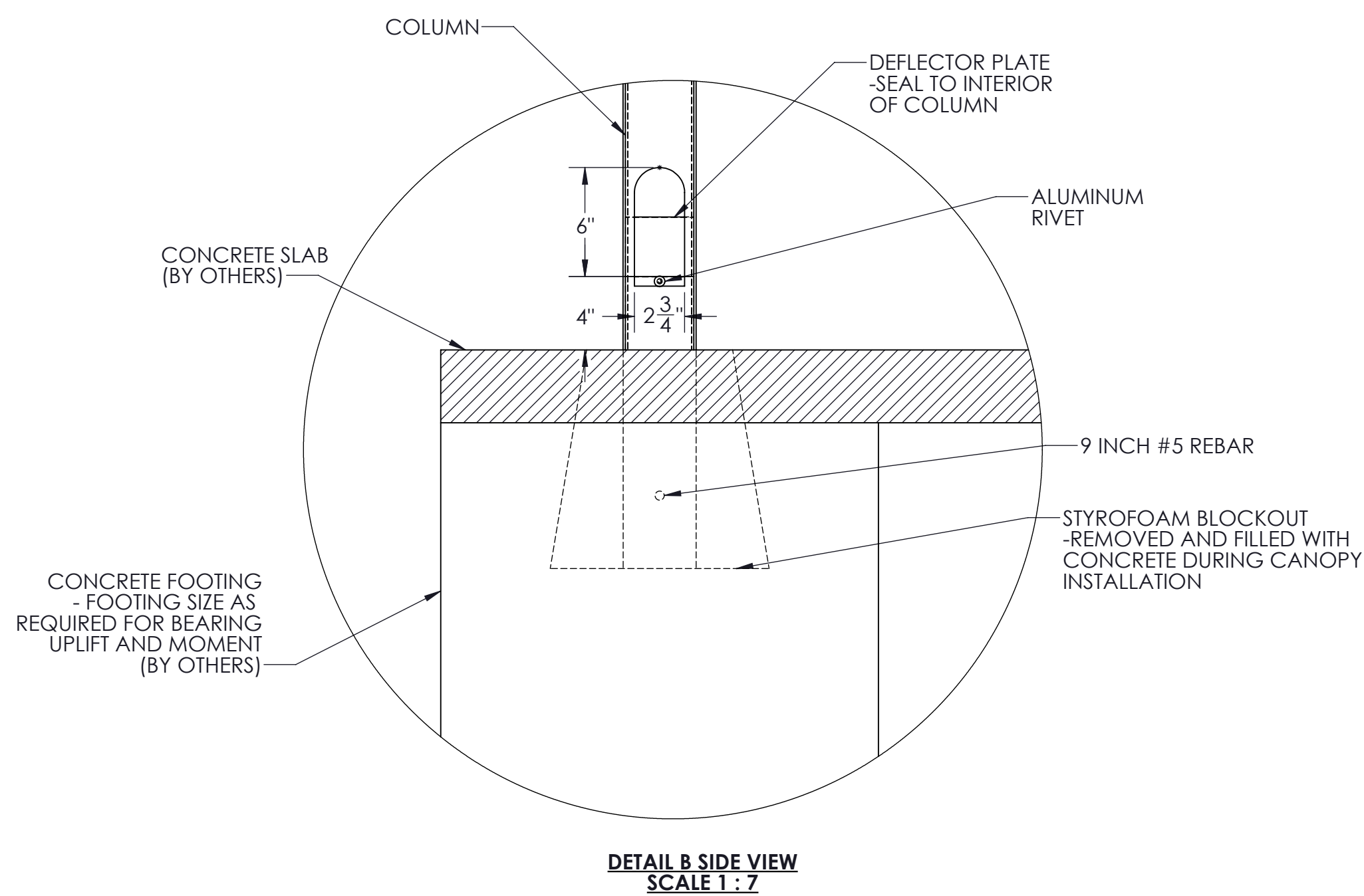
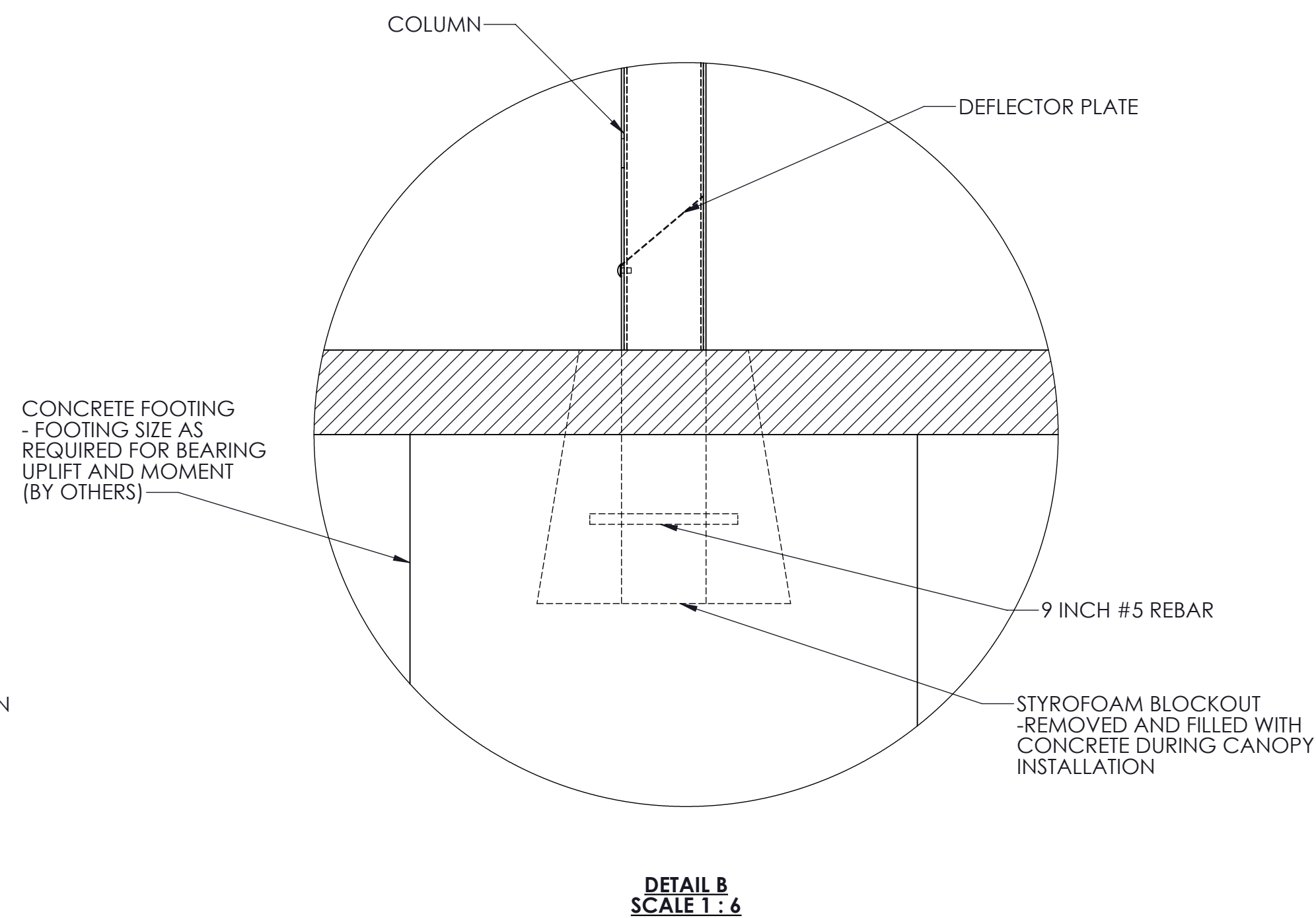
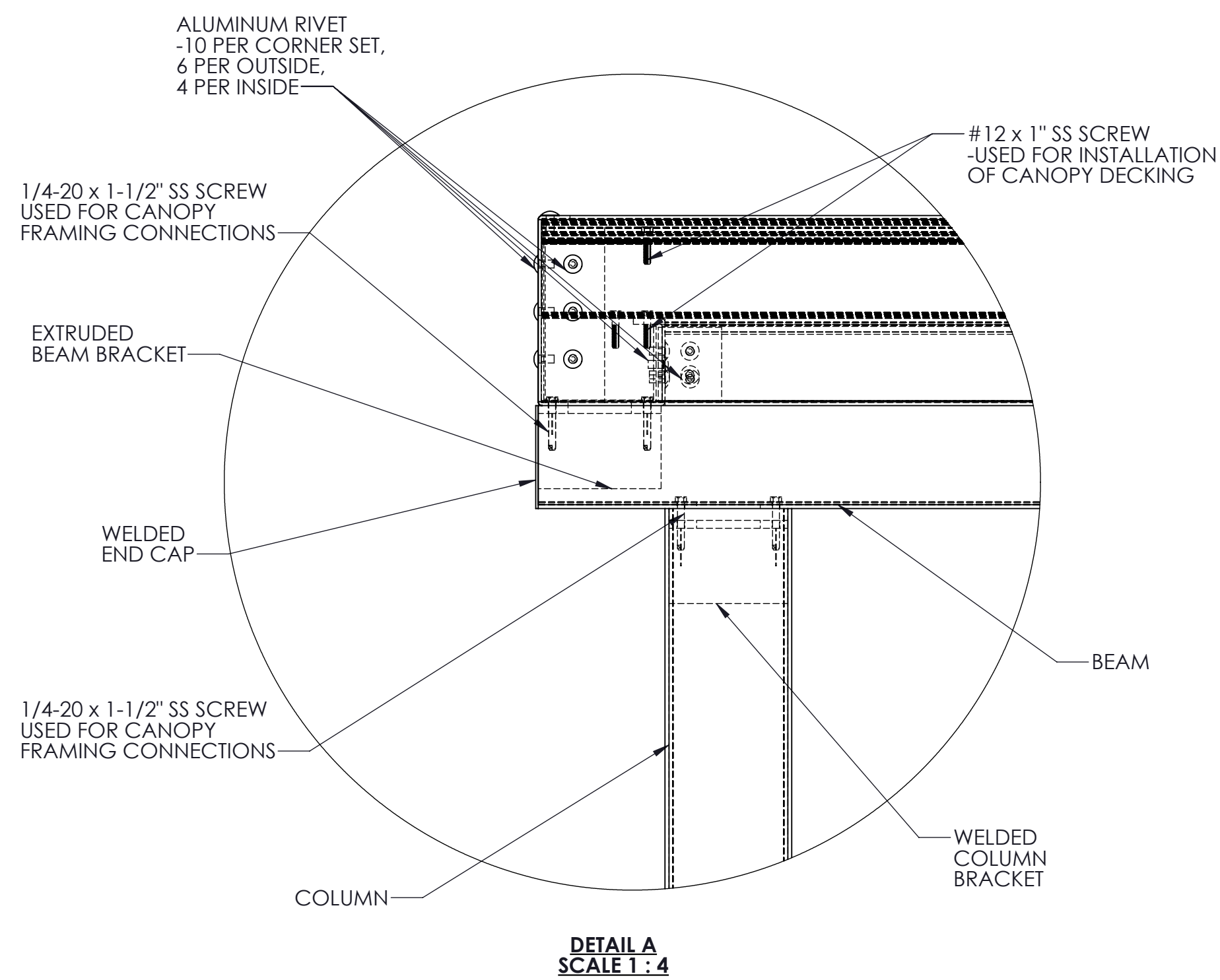

## ISOMETRIC VIEW OF CANOPY

### SPECIFICATIONS

Section 107300 - Aluminum Walkway Covers

#### 1.01 General Description of Work:

- A. Work in this section shall include design and fabrication of pre-engineered aluminum canopies.  
B. Canopies are to be fabricated and installed according to approved shop drawings.

#### 1.02 Design Criteria:

- A. International Building Code 2015  
B. ASCE 7-10  
C. Aluminum Design Manual 2015  
D. Local governing codes and standards for site location

#### 1.03 Materials:

- A. All materials shall be extruded from aluminum unless indicated otherwise on the drawing.  
B. Material sizes shall meet or exceed the design criteria on 1.02

#### 1.04 Finishes:

- A. Factory applied baked enamel to comply with AAMA 2603  
B. Color selected from manufacturers standard colors

#### 1.05 Manufacturers:

- A. Mitchell Metals, LLC - www.mitchellmetals.net - 770-431-7300  
B. Dittmer - www.dittdeck.com - 407-699-1755  
C. See Specifications 2.1-C for conditions of equivalent systems by other manufacturers.

### NOTES:

- [DC] = DRAINING COLUMN (IF APPLICABLE)
- CANOPY WIDTH RECOMMENDED NOT TO EXCEED 13'-0"
- COLUMN HEIGHT RECOMMENDED NOT TO EXCEED 12'-0" OR WIDTH OF CANOPY, WHICH EVER IS LOWER
- ALL FASTENERS TO BE 300 SERIES STAINLESS STEEL OR ALUMINUM

STAMP

JOB NAME:

Aluminum  
Walkway  
Covers

TITLE:

SHORTWAYS  
WITH BEAMS

REVISION # :

DATE: 9/13/2017 SHEET 1 OF 1