

SECTION VIEW OF CANOPY

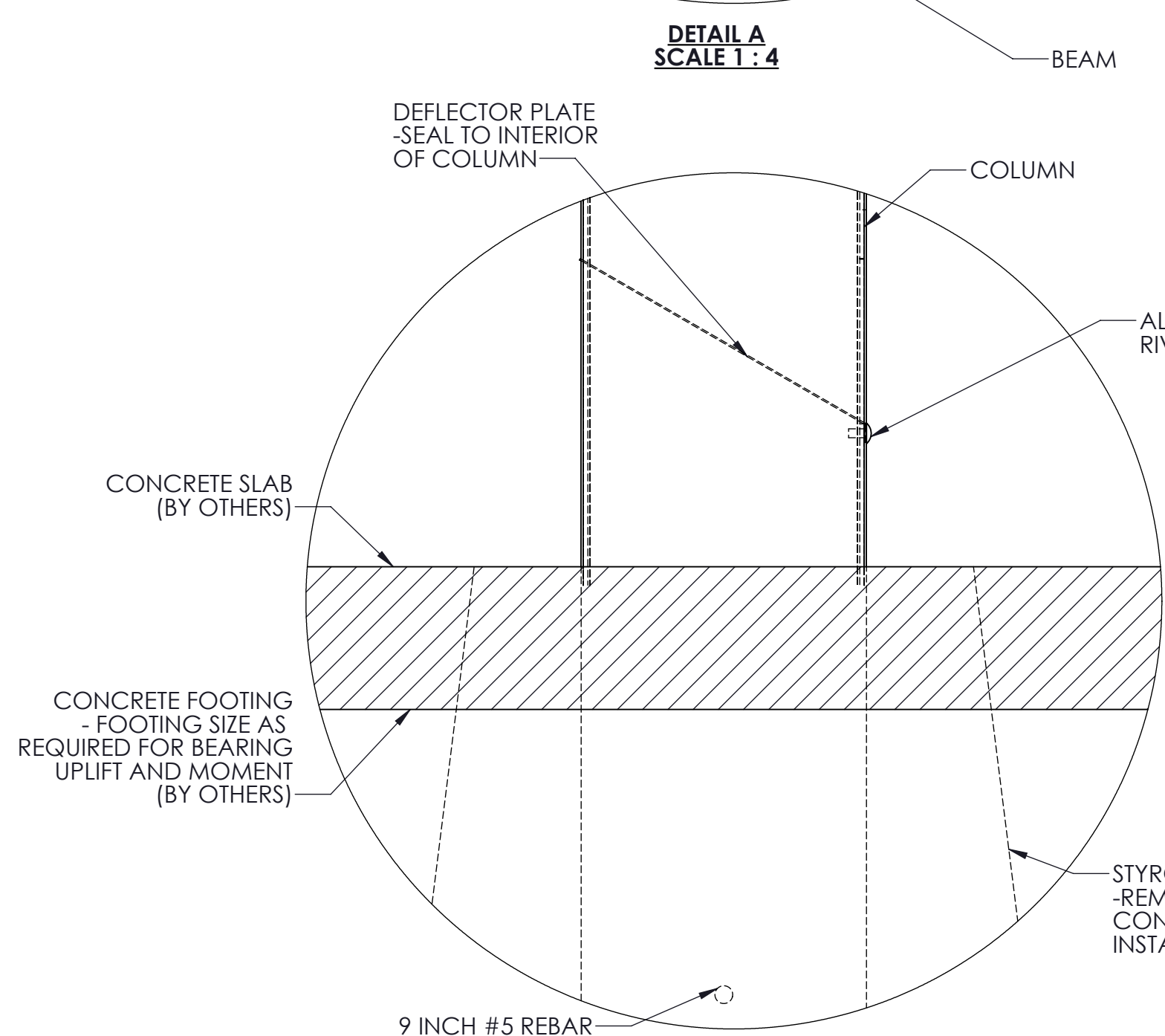

DETAIL A
SCALE 1 : 4

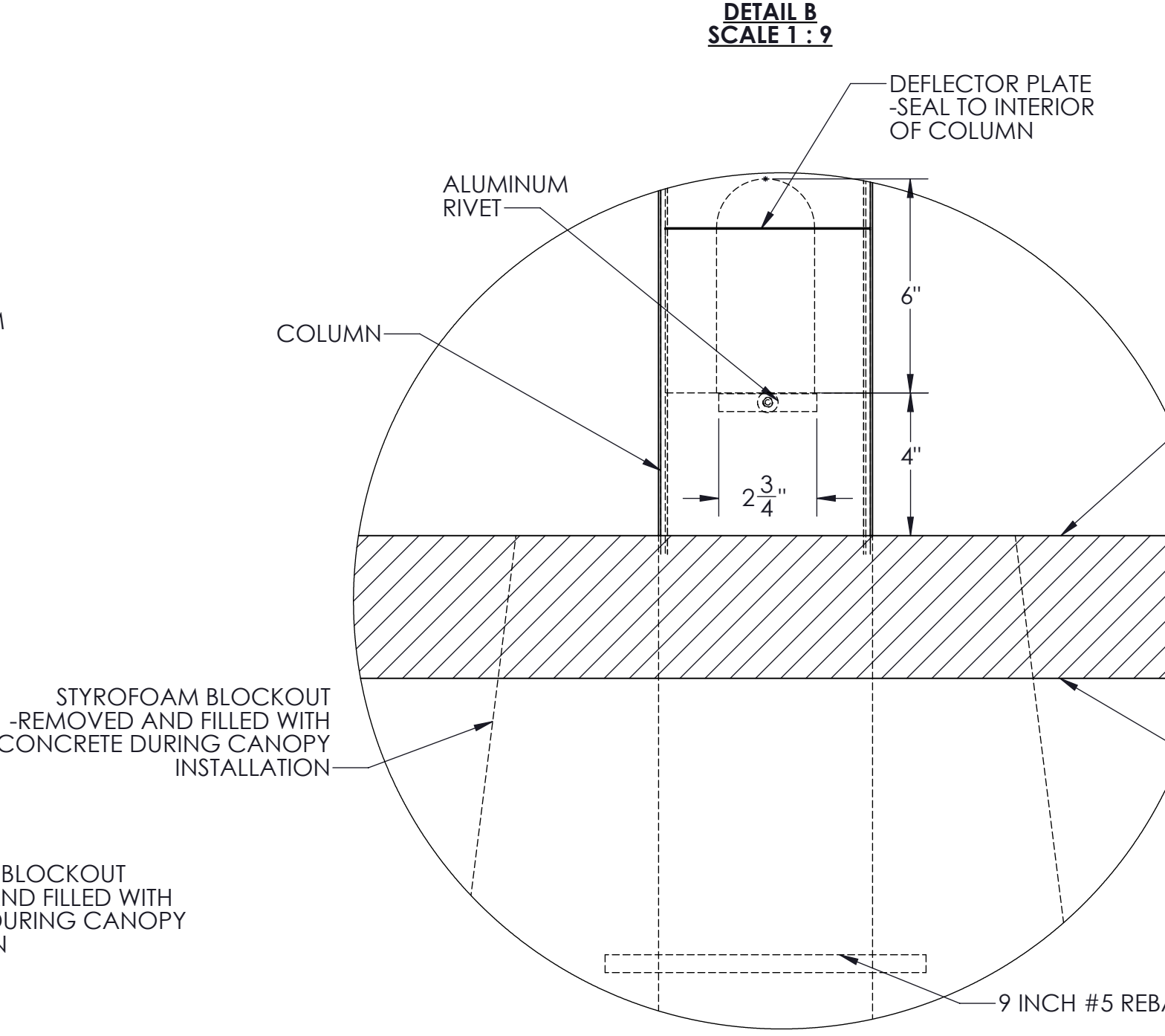

DETAIL B
SCALE 1 : 9

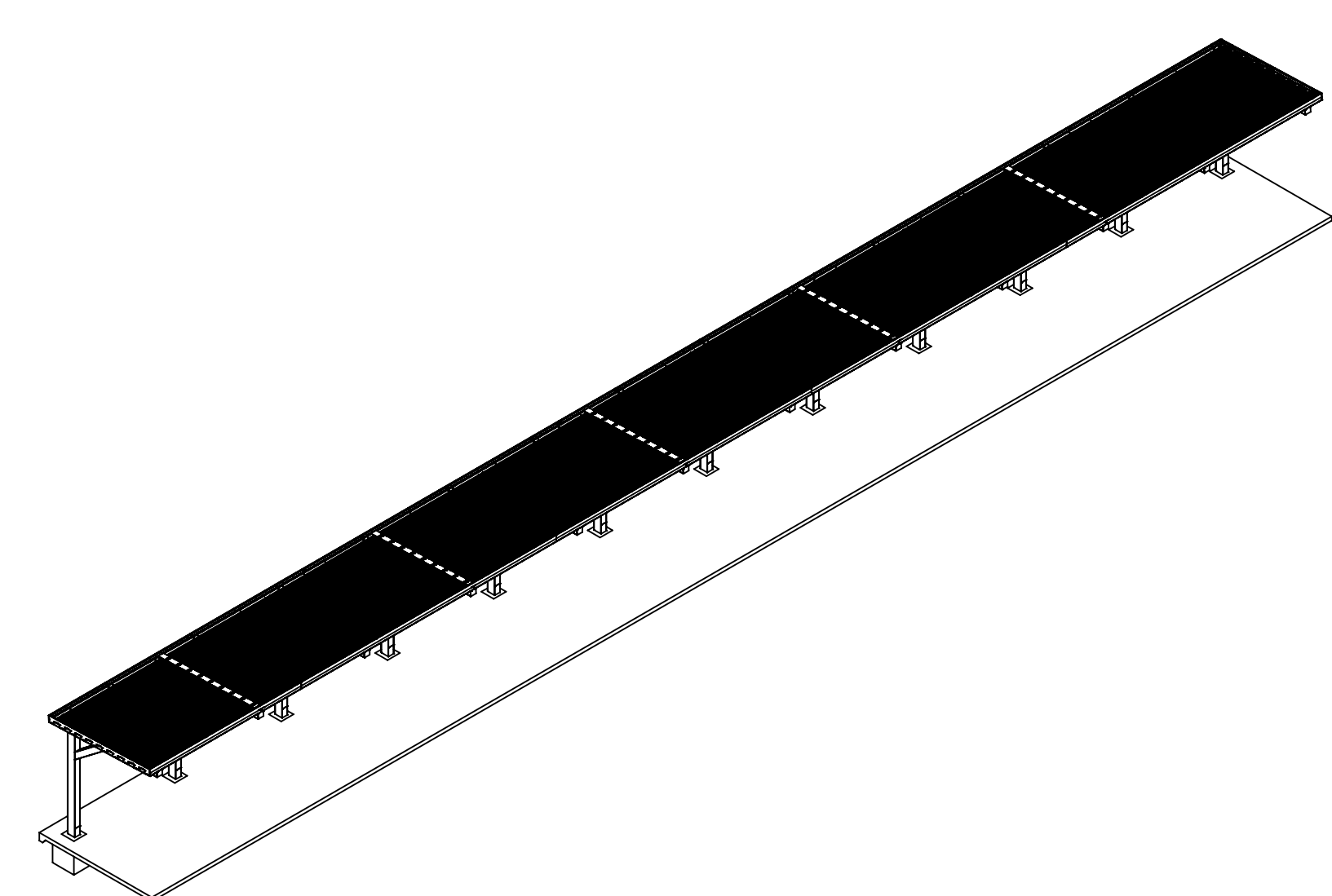

ISOMETRIC VIEW OF CANOPY

SPECIFICATIONS
Section 107301 - Cantilevered Walkway Cover

1.01 General Description of Work:
A. Work in this section shall include design and fabrication of pre-engineered aluminum canopies.
B. Canopies are to be fabricated and installed according to approved shop drawings.

1.02 Design Criteria:
A. International Building Code 2015
B. ASCE 7-10
C. Aluminum Design Manual 2015
D. Local governing codes and standards for site location

1.03 Materials:
A. All materials shall be extruded from aluminum unless indicated otherwise on the drawing.
B. Material sizes shall meet or exceed the design criteria on 1.02

1.04 Finishes:
A. Factory applied baked enamel to comply with AAMA 2603
B. Color selected from manufacturers standard colors

1.05 Manufacturers:
A. Mitchell Metals, LLC - www.mitchellmetals.net - 770-431-7300
B. Dittmer - www.dittdeck.com - 407-699-1755
C. See Specifications 2.1-C for conditions of equivalent systems by other manufacturers.

NOTES:

- **DC** = DRAINING COLUMN (If Applicable)
- **HEIGHT RECOMMENDED NOT TO EXCEED 12'-0" OR WIDTH OF CANOPY, WHICHEVER IS LOWER**
- **ALL FASTENERS TO BE 300 SERIES STAINLESS STEEL OR ALUMINUM**

STAMP	JOB NAME:
	Cantilevered Walkway Cover
	TITLE:
	Cantilevered Canopy
	REVISION # :
	DATE: 8/16/2017 SHEET 1 OF 1